

1 Before Flight...

(See manual for complete instructions)

- Install 4 "AA" batteries in the transmitter.
- Fully charge your Flight Battery.
- Find a safe and open outdoor area to fly.
- Plan flight based on flying area conditions (to take off and land into the wind, avoid the sun in your eyes, etc.).
- Set a flight timer for the recommend first flight time of **10 min.**

2 Turning ON the aircraft... (See manual for complete instructions).

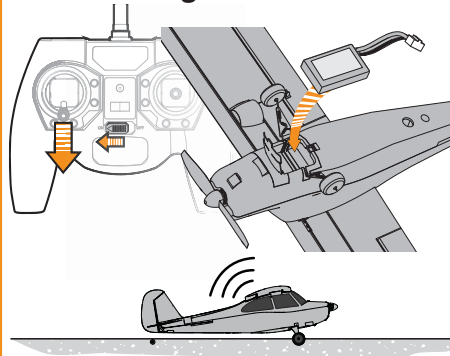

1. Power ON the transmitter.
2. Fully lower throttle stick and trim.
3. Install and connect flight battery to aircraft, then the ailerons will go up.
4. Set the aircraft on the ground on its landing gear in the center of the flying area. The ailerons will return to center to indicate the transmitter is connected.
5. Keep aircraft immobile on landing gear for up to 90 seconds to allow the aircraft to establish GPS lock. Audible tones will indicate the aircraft is ready to fly, and only then will control be passed to the transmitter.

3 Takeoff...

For your first flight, place the aircraft in **Beginner Mode** (switch position 0)

Place the aircraft in the center of the flying area **facing into to the wind**. Secure the aircraft to keep it from taking off. Advance the throttle to 100% then lower it to 0% to set the landing direction (heading) for the AutoLand function.

Pick up the aircraft and advance the throttle to 100%, and with the nose level or slightly up, launch it into the wind with a light toss. Slowly pull back on the elevator to gain altitude.

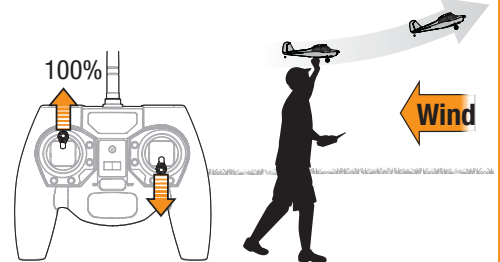
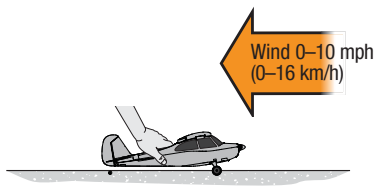
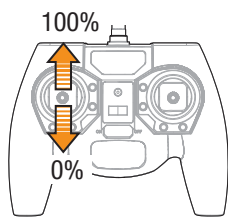
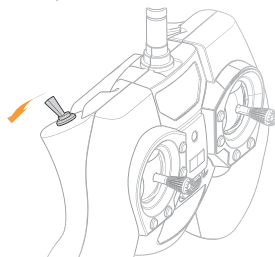

4 Flying...

Altitude is your friend!

1. Let the aircraft climb until it reaches 100 feet.
2. Explore the flight characteristics of your aircraft. Make small, gentle control stick movements to learn how your aircraft responds.

In Beginner mode, your aircraft will climb at full throttle without use of the elevator stick.

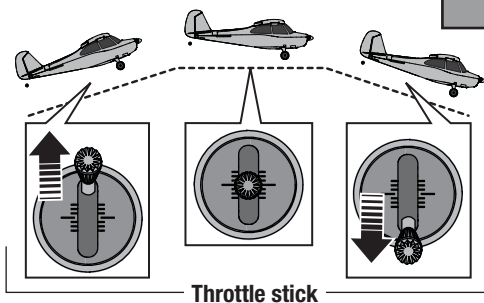

Throttle stick

Throttle Control
Push forward to increase speed/climb, pull back to decrease speed/descent.

Rudder Control
Aircraft yaw control. Left and right steering on the ground.

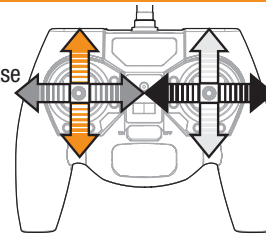

Aileron Control
Aircraft turning/banking left and right.

Elevator Control
Aircraft pitch control, pull back to pitch up, push forward to pitch down.

Remember...

If you feel you have lost orientation of the aircraft, switch to beginner mode and release the control sticks. The SAFE® technology will return the aircraft to stable flight (wings level).

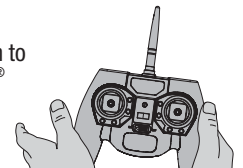

Virtual Fence

If you approach the 450ft (137m) boundary of the Virtual Fence, the aircraft will automatically take control, turn around and come back to you. It will then wag its wings and give control back to the transmitter.

Holding Pattern

If at anytime the aircraft seems too far away, a quick press and release of the Red (HP/AL) button on the transmitter will return the aircraft back to you. It will then begin to fly a circular pattern at an altitude of approximately 65 ft (20m) over the takeoff location. When the aircraft is in HP, it flies fully autonomously. The transmitter sticks have no control. To return to normal flight, press and release the HP/AL button again or change the flight mode.

5 Landing...

Land your aircraft into the wind.



Press and release again to abort landing.

Press and hold the Red (AL) Button for approximately 4 seconds to automatically land the aircraft

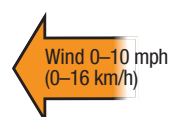

Rudder to steer

6 After Flight...

- Immediately remove the flight battery from the aircraft.
- Power off the transmitter.
- Inspect aircraft for damage.
- Make notes from flight experience and plan for future flights.

